

REQUIRED TOOLS AND JIGS (PROVIDED)

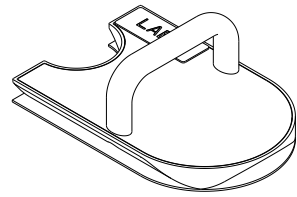

MODULE REMOVAL TOOL
(0A-2238-9999)

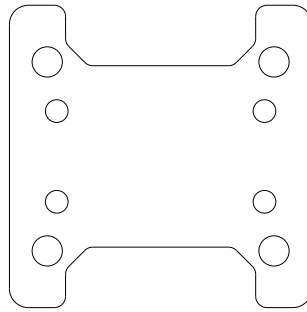

PANEL FLATTENING JIG
(0M-4671476)

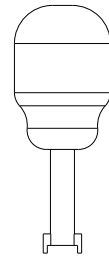

MAGNET Z-ADJUST TOOL
(TH-4176465)

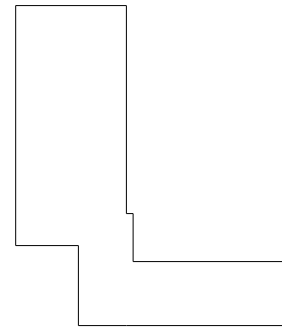

PANEL POSITIONING JIG
(0M-4748002)

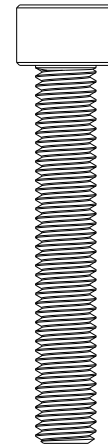

FLATTENING JIG BOLTS
M8-1.25X50
(HC-4084277)

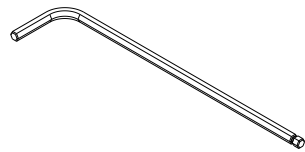

2.5MM HEX KEY
(TH-4747832)

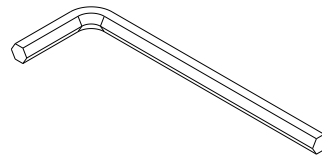

5MM HEX KEY
(TH-4747831)

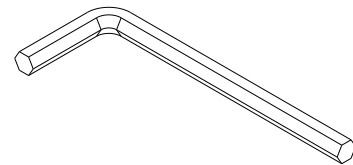

6MM HEX KEY
(TH-4747833)

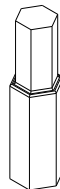

5MM HEX BIT
1/4" DRIVE
(TH-4747830)

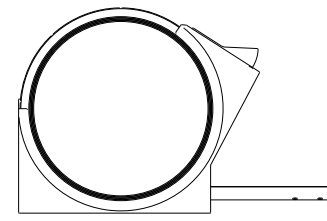

TAPE MEASURER



3/8" SOCKET

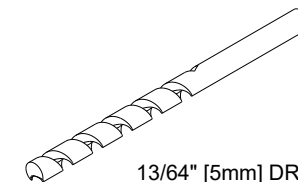

13/64" [5mm] DRILL BIT

REQUIRED TOOLS (NOT PROVIDED)

TOOL
SURGICAL (NITRILE) GLOVES: FOR MODULE HANDLING
STRING LINE
MARKER
1/4" [6MM] CENTER-LOCATING PUNCH
VACUUM

REQUIRED HARDWARE (PROVIDED)



M4-0.7X6 BTN HEAD HEX DRIVE SCREW
PN# HC-4729087
(BORDER HARDWARE)

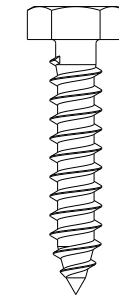

1/4"-10X1-1/2" LAG BOLT
PN# HC-4284469
(TUBE TO PLYWOOD MOUNTING)

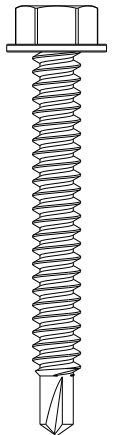

1/4"-14X2" HEX WASHER HEAD
PN# HC-4044048
(ALT. TUBE MOUNTING)

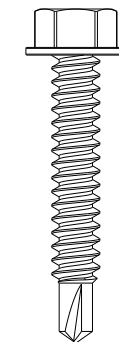

1/4"-14X1-1/2" HEX WASHER HEAD
PN# HC-3880111
(PANEL MOUNTING)

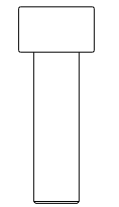

M6-1.0X20 CAP SCREW HEX DRIVE
PN# HC-1795
(Z-ADJUST AND STITCH HARDWARE)

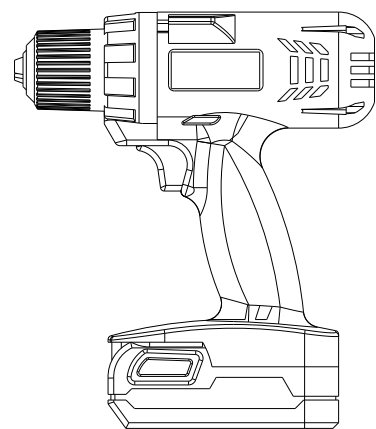

CORDLESS DRILL

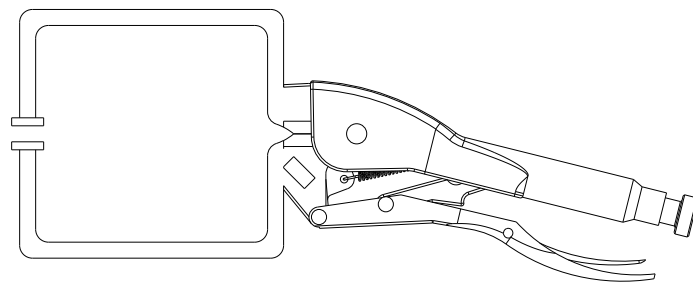

C-CLAMPS

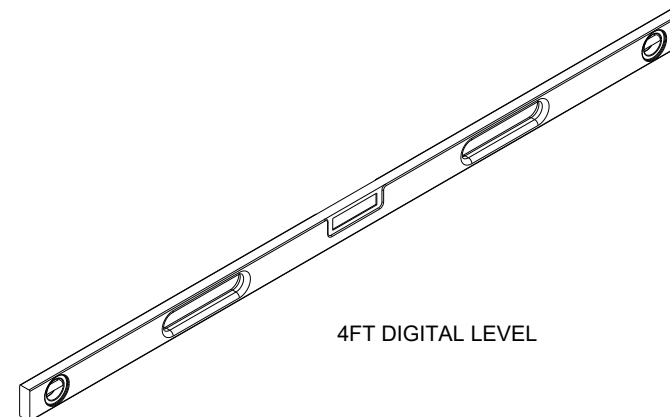

4FT DIGITAL LEVEL

REV: 01	DATE: 18 OCT 21	PER CN-129273: UPDATED RECOMMENDED TOOLS AND HDWE PER INSTALLATION REQUEST	BY: LJH 07198
PROJECT: NPN D1		THIRD ANGLE PROJECTION	
<p>THE CONCEPTS EXPRESSED AND DETAILS SHOWN ON THIS DRAWING ARE CONFIDENTIAL AND PROPRIETARY. DO NOT REPRODUCE BY ANY MEANS WITHOUT THE EXPRESS WRITTEN CONSENT OF DAKTRONICS, INC. OR ITS WHOLLY OWNED SUBSIDIARIES. COPYRIGHT 2021 DAKTRONICS, INC. (USA)</p>			
TITLE: RECOMMENDED TOOLS AND HARDWARE; NPN D1		SHEET 01	
DATE: 18-OCT-21	DIM UNITS: INCHES [MILLIMETERS]	REV 01	
SCALE: 1/1	DO NOT SCALE DRAWING		
DESIGN: KHEMILL	JOB NO. P2238	FUNC - TYPE - SIZE E - 07 - B	4756039
DRAWN: KHEMILL			